

Accessories Mod. Puffer B

B Type Puffer

| Articolo Article Artikel | Dimension | | Compression | | | | Shear | | | |
|--------------------------------|---------------|---------------|---------------|------------|------|-----|---------------|------------|------|-----|
| | D x H (mm) | G x L (mm) | Load (daN) | C = daN/cm | | | Load (daN) | C = daN/cm | | |
| | | | | h | m | w | | h | m | w |
| B 10x8 | 10x8 | M4x10 | 5 | 64 | 44 | 22 | 1,5 | 14,8 | 10,2 | 5,7 |
| B 16x15 | 16x15 | M4x10 | 10 | 106 | 66 | 30 | 3 | 19,2 | 13,3 | 7,4 |
| B 20x20 | 20x20 | M6x18 | 15 | 121 | 83 | 50 | 6 | 24 | 16 | 9,3 |
| B 20x25 | 20x25 | M6x18 | 15 | 84 | 58 | 36 | 6 | 18 | 13 | 7,1 |
| B 25x20 | 25x20 | M6x18 | 25 | 195 | 138 | 86 | 10 | 40 | 27 | 14 |
| B 30x25 | 30x25 | M8x20 | 35 | 202 | 136 | 89 | 15 | 45 | 30 | 16 |
| B 30x30 | 30x30 | M8x20 | 35 | 155 | 107 | 65 | 15 | 35 | 24 | 13 |
| B 40x30 | 40x30 | M8x23 | 60 | 303 | 192 | 130 | 25 | 63 | 43 | 24 |
| B 40x40 | 40x40 | M8x23 | 60 | 195 | 136 | 83 | 25 | 45 | 31 | 17 |
| B 50x20 | 50x20 | M10x25 | 100 | 1587 | 1000 | 540 | 40 | 160 | 110 | 61 |
| B 50x30 | 50x30 | M10x25 | 100 | 571 | 395 | 219 | 40 | 98 | 68 | 37 |
| B 50x40 | 50x40 | M10x25 | 100 | 369 | 260 | 147 | 40 | 71 | 49 | 27 |
| B 75x50 | 75x50 | M12x37 | 220 | 733 | 507 | 281 | 90 | 129 | 90 | 50 |
| B 75x55 | 75x55 | M12x37 | 220 | 637 | 438 | 243 | 90 | 117 | 81 | 45 |
| B100x40 | 100x40 | M16x44 | 400 | 2877 | 1951 | 982 | 150 | 319 | 221 | 122 |
| F = G | | | | | | | | | | |

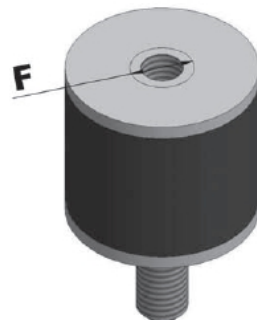

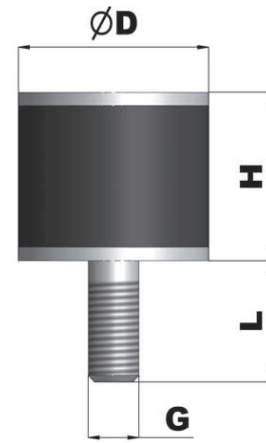

Technical Specifications

Puffer tipo B

| Articolo | Dimensioni (mm) | | | Compression | | | |
|----------|-----------------|--------|-----|-------------|----------|------|-----|
| | DxH | GxL | F | Load daN | C=daN/cm | | |
| | | | | | h | m | w |
| B 10x8 | 10x8 | M 4x10 | M4 | 5,0 | 64 | 44 | 22 |
| B 16x15 | 16x15 | M 4x10 | M4 | 10,0 | 106 | 66 | 30 |
| B 20x20 | 20x20 | M 6x18 | M6 | 15,0 | 121 | 83 | 50 |
| B 20x25 | 20x25 | M 6x18 | M6 | 15,0 | 84 | 58 | 36 |
| B 25x20 | 25x20 | M 6x18 | M6 | 25,0 | 195 | 138 | 86 |
| B 30x25 | 30x25 | M 8x20 | M8 | 35,0 | 202 | 136 | 89 |
| B 30x30 | 30x30 | M 8x20 | M8 | 35,0 | 155 | 107 | 65 |
| B 40x30 | 40x30 | M 8x23 | M8 | 60,0 | 303 | 192 | 130 |
| B 40x40 | 40x40 | M 8x23 | M8 | 60,0 | 195 | 136 | 83 |
| B 50x20 | 50x20 | M10x25 | M8 | 100,0 | 1587 | 1000 | 540 |
| B 50x30 | 50x30 | M10x25 | M10 | 100,0 | 571 | 395 | 219 |
| B 50x40 | 50x40 | M10x25 | M10 | 100,0 | 369 | 260 | 147 |
| B 75x50 | 75x50 | M12x37 | M12 | 220,0 | 733 | 507 | 281 |
| B 75x55 | 75x55 | M12x37 | M12 | 220,0 | 634 | 438 | 243 |
| B 100x40 | 100x40 | M16x44 | M16 | 400,0 | 2877 | 1951 | 982 |